



CENTRE REGION CODE ADMINISTRATION

2643 Gateway Drive, Suite #1, State College, PA 16801

814-231-3056

www.crcog.net/crca

Emergency Directional Signage

Prior to ordering any emergency directional signs, we highly encourage that the following information be submitted to our office:

- A site plan of the premises showing all entrances and travel ways, all habitable buildings with the building number or letter clearly marked, the intended location of the emergency directional signs, and any obstructions at intersection areas such as dumpsters, mailbox clusters, transformer pads, etc...
- Separate submissions showing the intended content of each emergency directional sign.

Example:

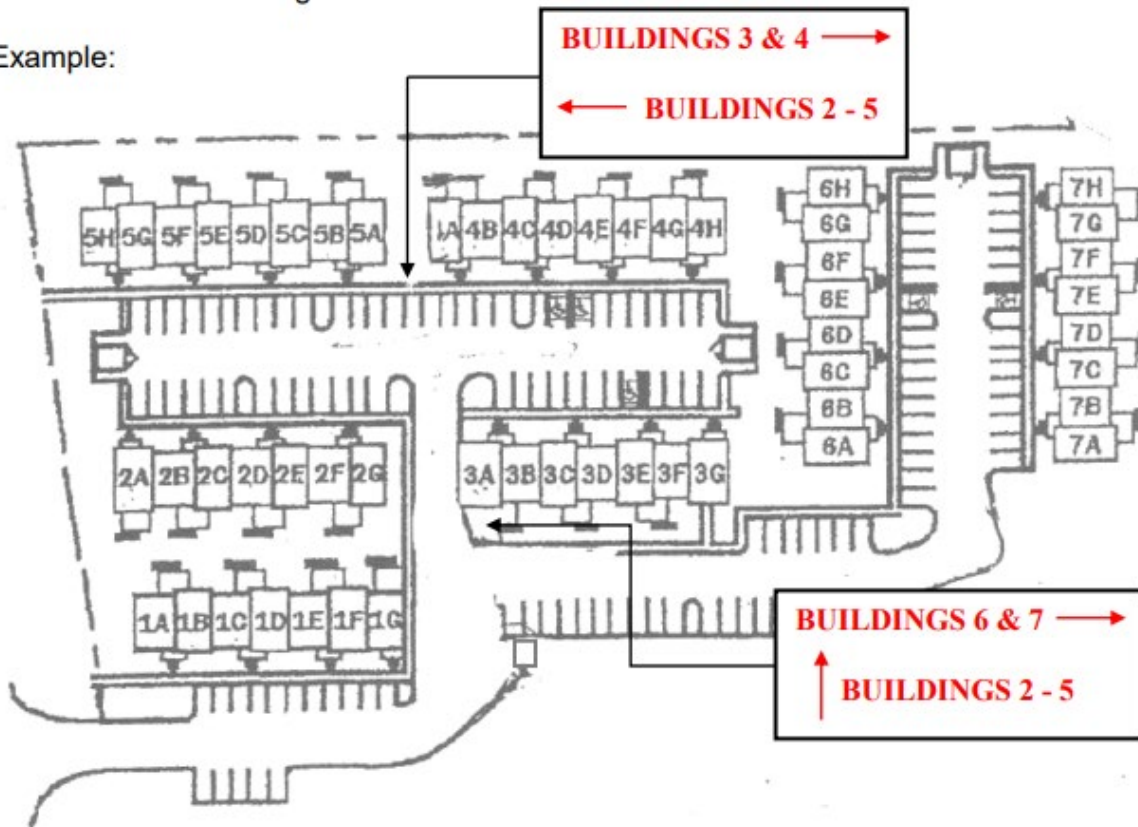

Upon submission to the Code Office, the Existing Structures Staff will review all signage proposals to ensure accurate and proper signage.

Emergency Directional Signage Specifications

- Signs are to be constructed of a weatherproof material
- White background
- All letters, numbers, and arrows shall be reflective red material
- Letters and numbers are to be no less than 4" high, with a ½" stroke width
- Directional arrows are to be no less than 12" in length, ½" stroke width, arrow heads to have a minimum of 4" in length and 2" in width
- Minimum 4" clear border is required on all sides of signs
- Bottom of signs to be between 48"-54" above finished grade
- There are no size requirements for the overall signs. The signs need only be large enough to accommodate the required size letters, numbers, arrows, and border.
- Only building identification is permitted to be included on emergency directional signage. Company or location names, logos, etc... are not permitted

